

## SPECIFICATIONS

INPUT	3 x PC Input (*D-Sub 15pin) 2 x PC-Audio (*3.5mm) 1 x C-Video (*RCA) 1 x Stereo Audio (*RCA) 1 x Stereo Audio (*2.54mm connector, feedback from projector) 1 x Microphone (*3.5mm) 1 x Microphone (*6.3mm) 2 x HDMI (19 pin female)	
OUTPUT	2 x VGA output (*standard 2.54mm connector to Projector/Monitor) 1 x HDMI output (*19pin connector to Projector) 1 x C-Video (*standard 2.54mm connector) 1 x Main Stereo Audio (*standard 2.54mm connector) 1 x Tx (*standard 2.54mm connector) 1 x RS-232 (*standard 2.54mm connector)	
VGA BANDWIDTH	3-in 2-out VGA Switcher Distribution Amplifier (900MHz R+G+B)	
MAX. RESOLUTION	1920 x 1200	
ALL CABLE LENGTH	Up to 28 meter	
CONFIGURABLE COM PORT	1:2 x RS-232 (8 Data Bit and 1 Stop Bit) Baud Rate (1200 to 115200) Parity Bit (Non, Even or Odd) Programmable projector protocol	
DELAY TIME	Projector "ON/OFF" delay time (*in sec) 1 to 99	
CONTROL BUTTON	Number of user defined "Control Button" x 8 Available protocol for each "Control Button" x 1 With LED for indication and confirmation	
LED		
VIDEO SELECTION	All Video/VGA Switching	Digital
AUDIO SELECTION	Audio Switching	Digital
VOLUME	Main Volume Control	Analog
MIC. GAIN	Microphone Input Gain Control	Analog
POWER ADAPTOR	12V-DC	
MECHANICAL		
HOUSING	ABS enclosure	
PRODUCT		
DIMENSIONS (L x W x H)	149 x 88 x 48 mm (Standard UK two gang casing)	
WEIGHT	350g	

## TYPICAL APPLICATION

Any professional presentation system requiring multiple AV Inputs of all different type of video standard and a standard projector controller.

- Schools (Media Classroom) • Churches • Corporate Applications (Meeting Room)

**ABtUS**  
S I N G A P O R E

# Multimedia Controller Switcher

Programmed Integrated Projector Controller Switcher  
**With 2:1 HDMI Switcher with Building Buffer**



Model: **AVS-316**

# User Operation Guide

## PRODUCT DESCRIPTION

The **ABTUS AVS-316** Media Control Panel is one of the most user friendly and installer friendly projector controller switcher. Preprogrammed and specifically designed for an easy and central control of any AV projection system. It removes the need for over-complicated and multiple remote control handsets. With the 2:1 HDMI switcher inbuilt, users are now free to project any HD image to the display (Projector) with just a touch of a button.

## PRODUCT HIGHLIGHTS

- “User Programmable” with Window base Application Software
- Simple to use with one-to-one function control buttons
- Fully self contained / integrated Projector Controller with AV switcher (VGA Matrix switching)
- Supports 2:1 HDMI switcher with resolutions up to 1920x1080
- Easy Installation with standard 2.54mm connector and cabling

## BASIC CONNECTION AND OPERATION CONTROL

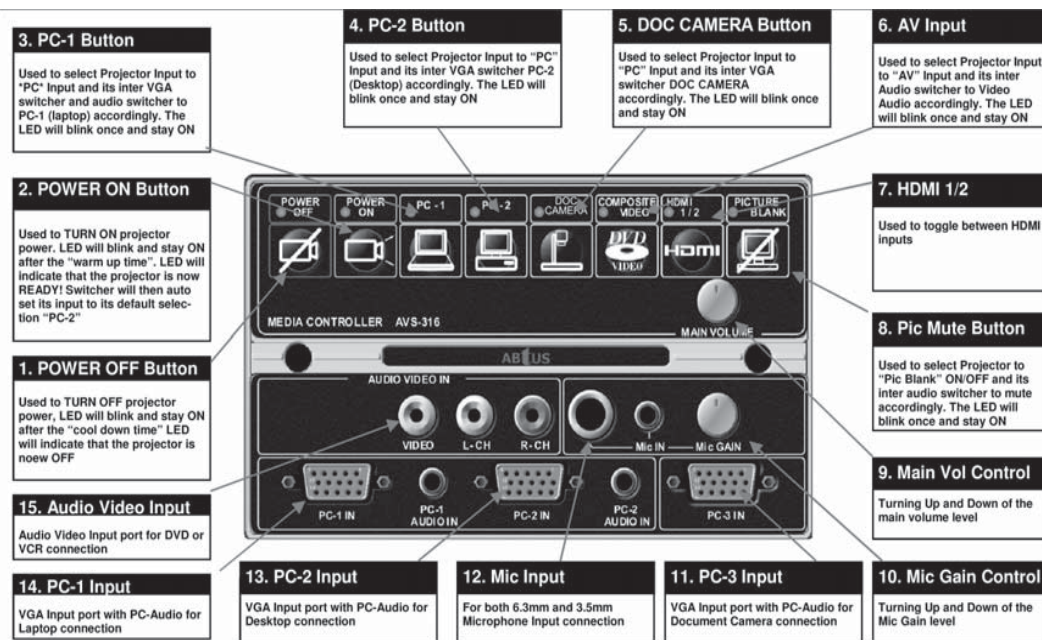

## INTERNAL PCB LAYOUT AND INTER CONNECTION

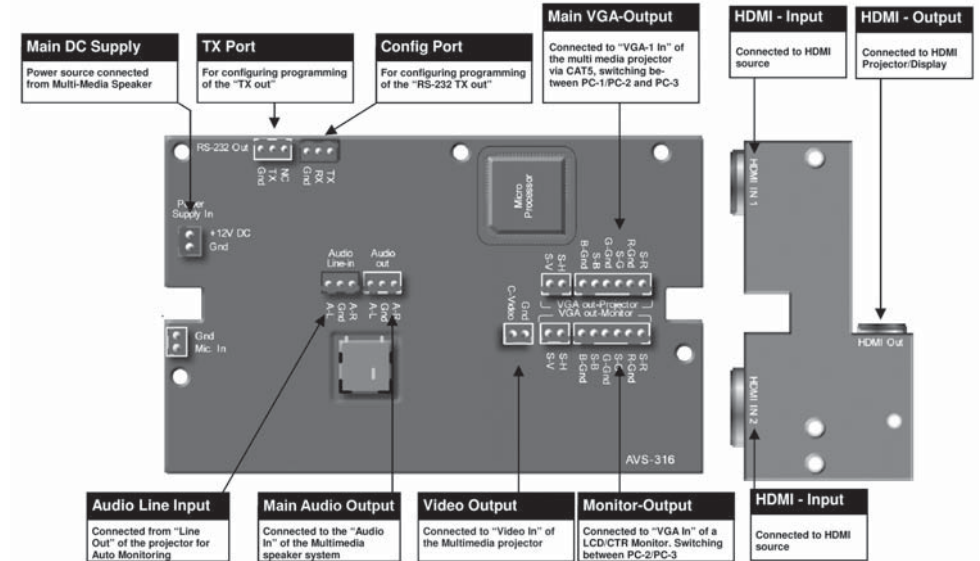

## CONFIGURATION DIAGRAM

