

# BEHRINGER V-TONE BASS BDI21

## WELCOME TO BEHRINGER

Thank you for showing your confidence in us by purchasing the V-TONE BASS BDI21. This high-quality bass driver is designed for bassists with diverse and wide-ranging needs. The integrated tube emulation produces the sound and response of a miked bass tube amp while the 2-band EQ (with presence control) and the dedicated drive control let you create any bass tone you desire, from vintage to modern. In addition, the BDI21 functions as a standard ultra-transparent direct injection box when used in bypass mode.

A DI (Direct Injection) box allows you to send a signal directly from an unbalanced, high-impedance output (like a bass guitar) and connect it directly to the balanced mic input of a mixing console.

Whether for stage, recording, rehearsal or warm-up, the BEHRINGER V-TONE BASS BDI21 is a natural choice for those who are seeking great tone with a simple set-up.

## CONTROL ELEMENTS

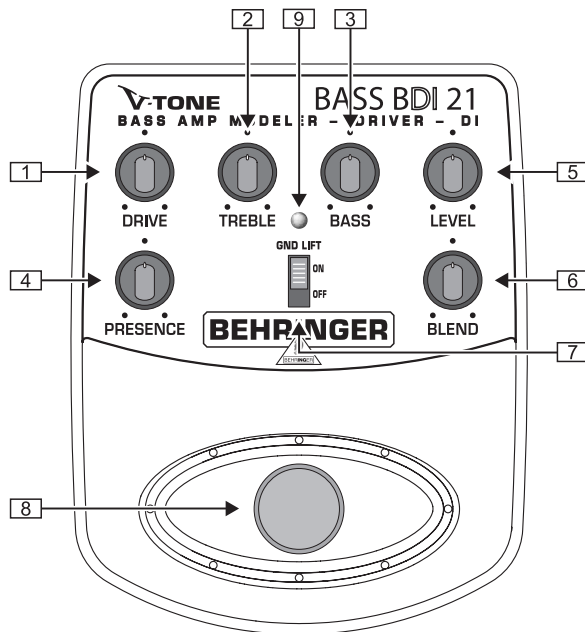

Control elements

- 1 The *DRIVE* control adjusts the overall amount of gain and overdrive, similar to pushing the output section of a tube amp.
- 2 The *TREBLE* control governs the high-frequency range of the signal (+/-12 dB).
- 3 The *BASS* control allows you to boost/cut the low-frequency range (+/-12 dB).
- 4 The *PRESENCE* control boosts the upper harmonic content for a smoother high end and more attack.
- 5 The *LEVEL* control adjusts the output level of the BDI21.
- 6 The *BLEND* control adjusts the amount of tube emulation. The tube emulation circuitry provides the real tube sound of a miked bass tube amp.
- 7 When activated, the *GND LIFT* disconnects the ground connection between input and output. Depending on the grounding of the connected equipment, this can eliminate hum or ground loops.

- 8 Use the footswitch to activate/deactivate all the tone functions (EQ, DRIVE, tube emulation). When deactivated, the BDI21 functions solely as a standard transparent DI box.
- 9 This LED illuminates when the effect is activated (see 8).

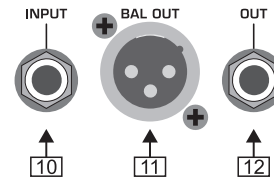

Connectors

- 10 Use this 1/4" TS *INPUT* connector to plug in the instrument cable of your bass guitar or other instruments.
- 11 *BAL OUT* is the BDI21's balanced mic level output. Use a high-quality, balanced XLR (microphone) cable to connect the driver to a mixing console.
- 12 The unbalanced 1/4" TS *OUT* connector sends the signal to your bass amp.

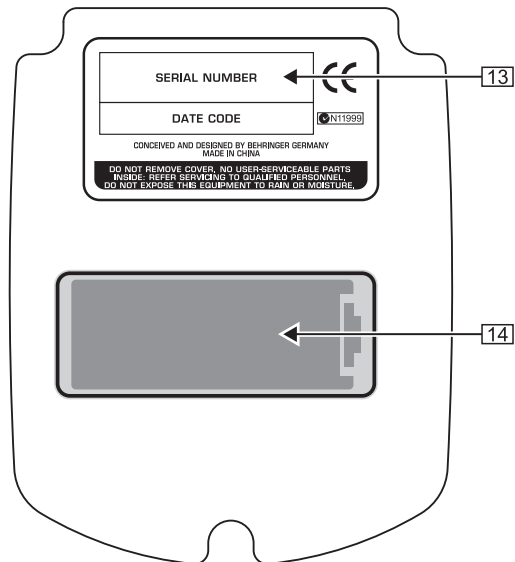

Bottom of the BDI21

- 13 *SERIAL NUMBER*. The serial number of the BDI21 is located on the bottom.
  - 14 *BATTERY COMPARTMENT*. Open the lid to install or replace the 9 V battery (see also chapter "POWER REQUIREMENTS").
-  The BDI21 is powered as soon you insert a plug into the *INPUT*. The battery is "disconnected" when the plug is removed. For this reason, the BDI21 has no on/off switch. To prolong battery life, always disconnect the input when the driver is not in use.

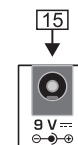

Power supply connector

- 15 Use the *DC IN* connection to plug in a 9 V power supply (not included). For details please refer to chapter "POWER REQUIREMENTS."

# BEHRINGER V-TONE BASS BDI21

## APPLICATIONS

### Use with other instruments

The BDI21 is not only for bass guitars. You can try it with other instruments (e. g. acoustic/electric guitars, keyboards etc.) to create new sounds and enhance your music. Please make sure that the input level is not too high to avoid overloading the BDI21.

### Direct to a mixing console

For live and studio applications you can connect the balanced XLR BAL OUT directly to a mic input of a mixing console. Be sure not to overload the input by using the gain control of the respective channel. For further information please refer to the user's manual of your mixing console.

### Use without instruments

You can use the BDI21 without an instrument as an outboard processor connected to an insert or an effect path (aux send/return) of your mixing console to affect the signal of a particular channel. This way you can enhance existing tracks during mixdown. For further information please refer to the user's manual of your mixing console.

## POWER REQUIREMENTS

### Battery:

Utilizes standard 9 V alkaline battery (not included).  
Power consumption: approx. 25 mA

### Power supply:

**ATTENTION: PLEASE USE DC POWER SUPPLY ONLY!**  
Failure to do so may damage the unit and void the warranty.

DC Power Supply Specifications:

- 9 V DC (regulated), 50 mA minimum
- 2 mm female plug, center negative (-)

## WARRANTY

For our current warranty terms, please refer to our website at <http://www.behringer.com>.

## SPECIFICATIONS

### Input

Connector 1/4" TS  
Impedance 1 M $\Omega$

### Output

Connector 1/4" TS  
Impedance 1 k $\Omega$

### Balanced output

Connector XLR  
Impedance 200  $\Omega$

Power supply 9 V, >50 mA DC regulated

Power connector 2 mm DC jack, negative center

Battery 9 V type 6LR61

Power consumption 25 mA

Dimensions approx. 5" (127 mm) x 3 9/10" (100 mm) x 2" (50 mm)

Weight approx. 460 g

## SAMPLE SETTINGS

### FAT TUBE

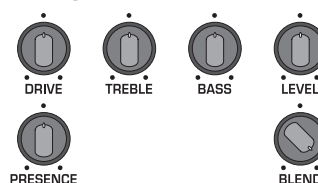

### SVT® STYLE

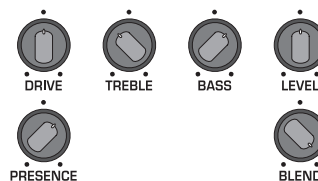

### SLAP

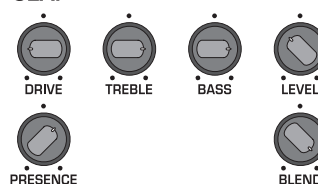

### REGGAE

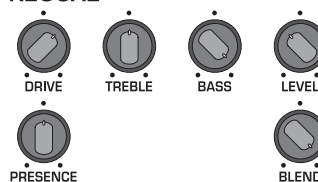

### SOLO

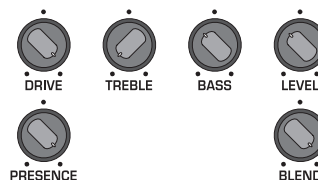

Technical specifications and appearance subject to change without notice. The information contained herein is correct at the time of printing. The names of companies, institutions or publications pictured or mentioned and their respective logos are registered trademarks of their respective owners. Their use neither constitutes a claim of the trademarks by BEHRINGER® nor affiliation of the trademark owners with BEHRINGER®. Any mention of samples settings by commercial organizations or reference to commercial organizations is for information only. It does not imply any affiliation of BEHRINGER with the samples settings mentioned nor does it imply recommendation or endorsement by BEHRINGER nor does it imply that the samples settings mentioned are necessarily the best available for the purpose. BEHRINGER® accepts no liability for any loss which may be suffered by any person who relies either wholly or in part upon any description, photograph or statement contained herein. Colours and specification may vary slightly from product. Products are sold through our authorised dealers only. Distributors and dealers are not agents of BEHRINGER® and have absolutely no authority to bind BEHRINGER® by any express or implied undertaking or representation. No part of this manual may be reproduced or transmitted in any form or by any means, electronic or mechanical, including photocopying and recording of any kind, for any purpose, without the express written permission of BEHRINGER Spezielle Studioteknik GmbH. BEHRINGER® is a registered trademark.

ALL RIGHTS RESERVED.

© 2004 BEHRINGER Spezielle Studioteknik GmbH,  
Hanns-Martin-Schleyer-Str. 36-38,  
47877 Willich-Münchheide II, Germany.  
Tel. +49 2154 9206 0, Fax +49 2154 9206 4903

BEHRINGER is constantly striving to maintain the highest professional standards. As a result of these efforts, modifications may be made from time to time to existing products without prior notice. Specifications and appearance may differ from those listed or illustrated.